

Electric Stand Installation Guide

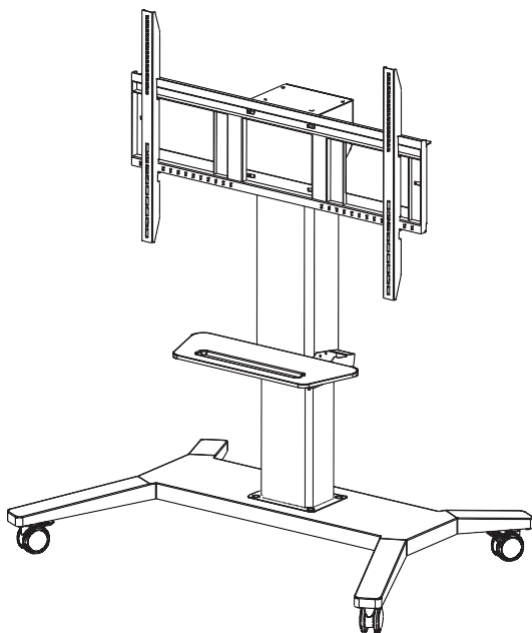

- For using this product properly and safely, please follow the contents of the Installation and Operation Manual to install.
- It is suggested that this Electric Stand applies to the 55-75 inch intelligent panel.
- This stand can carry a maximum weight of 100KG.

Accessories

- Base (1pcs)
- Lifting column (1pcs)
- Wall Mount (1pcs)
- Shelf(1pcs)
- Hanging bar (2pcs)
- Control pad (1pcs)
- AC Power Cable (1pcs)
- USB Cable(1pcs)
- AC Power transfer Cable (1pcs)

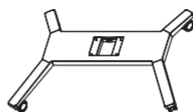

A -Base(1pcs)



B-Lifting column -(1pcs)

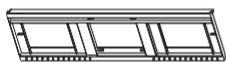

C-Wall Mount (1pcs)

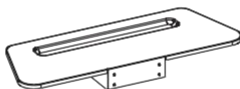

D-Shelf(1pcs)



E- Hanging bar (2pcs)



F-Control pad (1pcs)



G-AC Power Cable
(1pcs)



H-USB Cable
(1pcs)



I-AC Power transfer
Cable (1pcs)

①Hexagon socket countersunk head screws	KM10*25	4pcs	
②Cross recessed pocket hexagon head screw	M8*20	4pcs	
③Cross recessed pocket hexagon head screw	M5*15	2pcs	
④Cross recessed T-head with collar screw	TM4*6	4pcs	
⑤Plastic bolts	/	4pcs	
⑥Hex nut	6mm	1pcs	
⑦Cross recessed pocket hexagon head screw	M8*25	4pcs	
⑧Cross recessed pocket hexagon head screw	M6*20	4pcs	
⑨Cross screwdriver (Self-Provided)	/	1pcs	
⑩Monkey spanner (Self-Provided)	/	1pcs	

1

Step1: The shelf D is fixed with the lifting column B (figure 1).

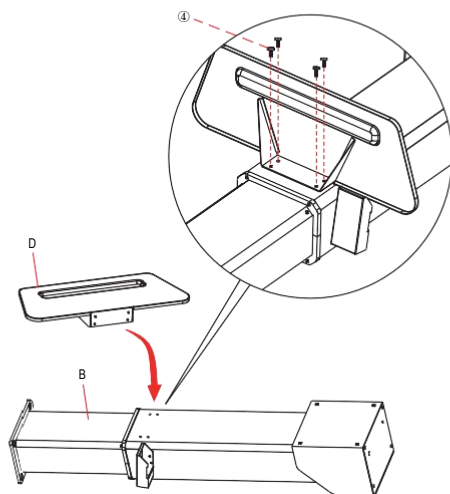

figure 1

2

Step2: Connect the power cable between the lifting column B and the base A, install the lifting column and tighten the screws (figure 2).

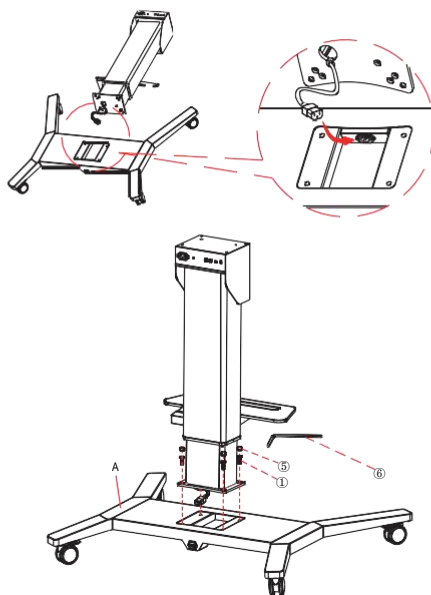

figure 2

3

Step3: Install the Wall Mount C on the lifting column B (figure 3).

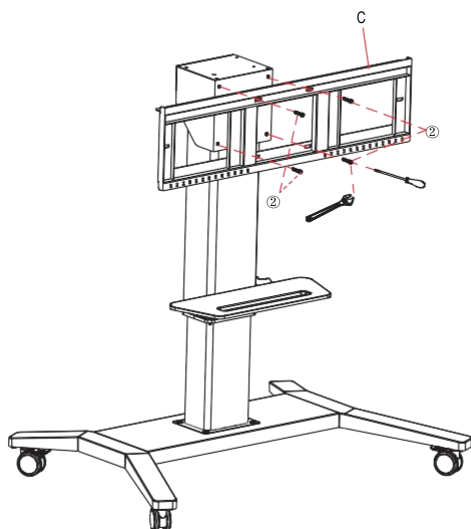

figure 3

4

Step4: Assemble the Interactive Flat Panel and hanging bar E with right screw (⑦or ⑧) based on actual use demand. (figure 4).

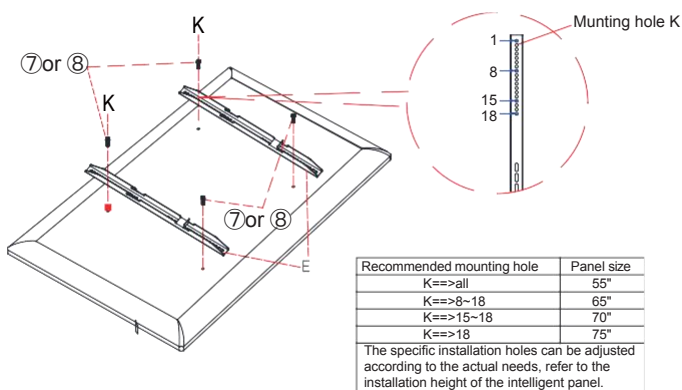

figure 4

5

Step5: Hang the Interactive Flat Panel to the Electric Stand by Wall Mount, and tighten the screws (figure 5).

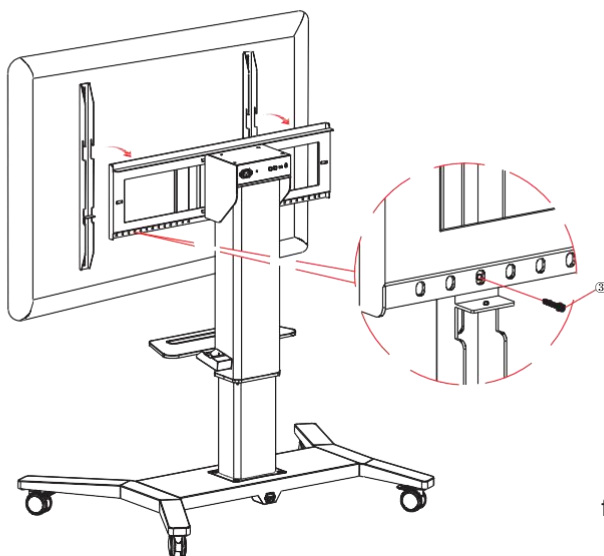

figure 5

6

Step6: When using the Electric Stand, the control pad and the AC power cable should be connected to the Electric Stand, and connected to the power supply (figure 6).

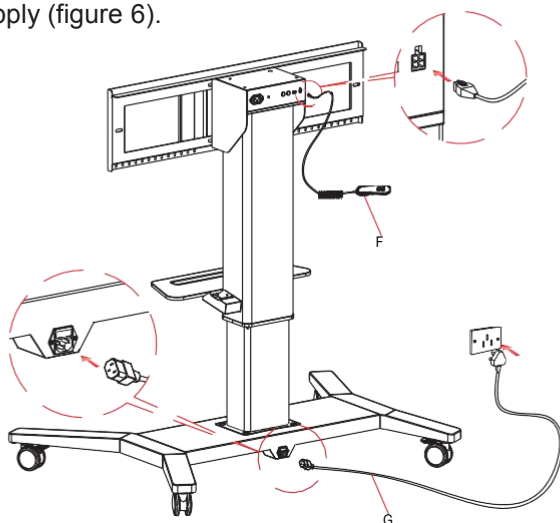

figure 6

7

Step7: Plugging the AC Power transfe Cable and the USB Cable in, user can interact with the Interactive Flat Panel (figure 7).

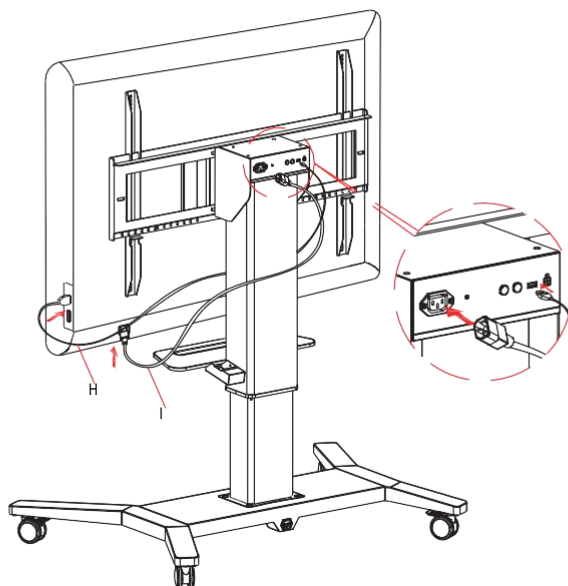

figure 7

8

Step8: Done, as shown in figure 8.

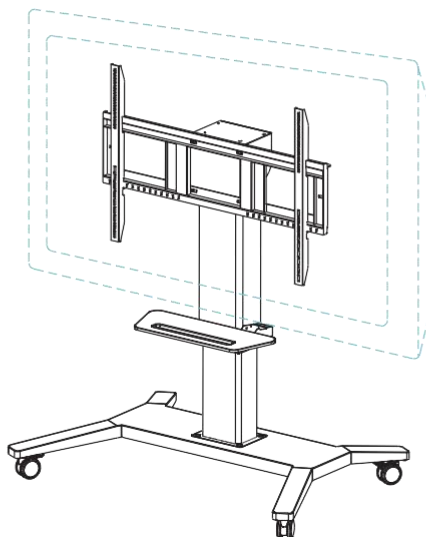

figure 8