



CLEVERTOUCH[®]
TECHNOLOGIES

by Boxlight[®]

Clevershare 5

How to guide



Contents Page

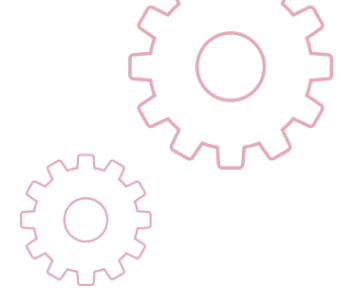

Clevershare 5	3
Establishing a connection	3
Accessing Clevershare settings	4
Main Menu & Settings	4
Allow this device to be discovered	5
Permission Mode	5
Screen sharing without client	6
Clevershare 5 app	7
Clevershare 5 Windows app	8
Device Management	9
Screen Copy	12
Additional Features when using Desktop Sync	13



Clevershare 5

Establishing a connection

Select the 6-digit code

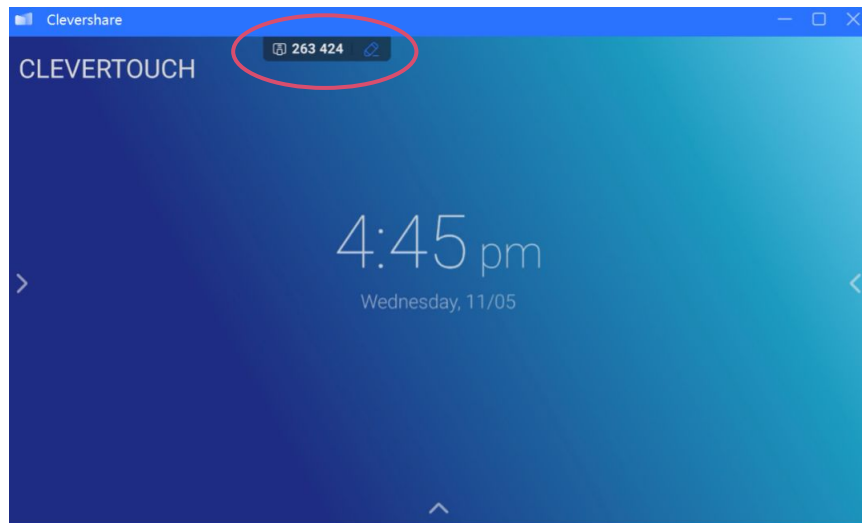

Select ***View the main interface***

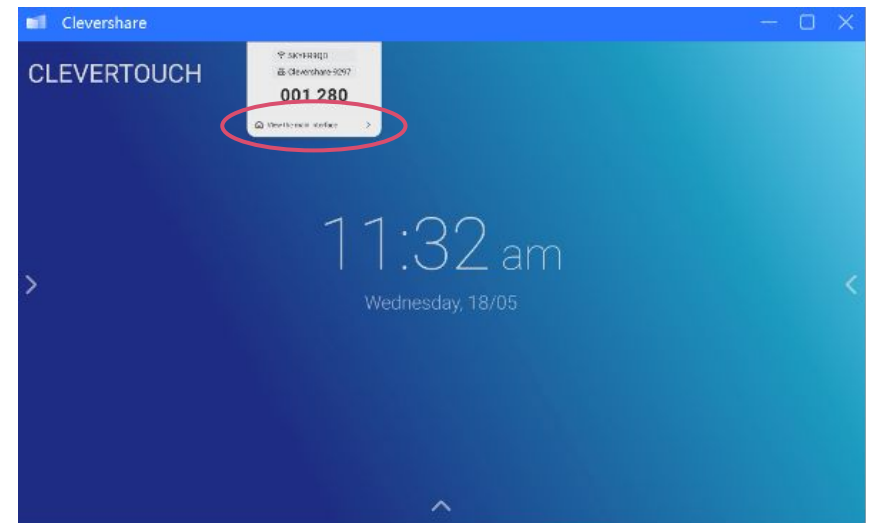

Accessing Clevershare settings

Main Menu & Settings

Select **Menu**

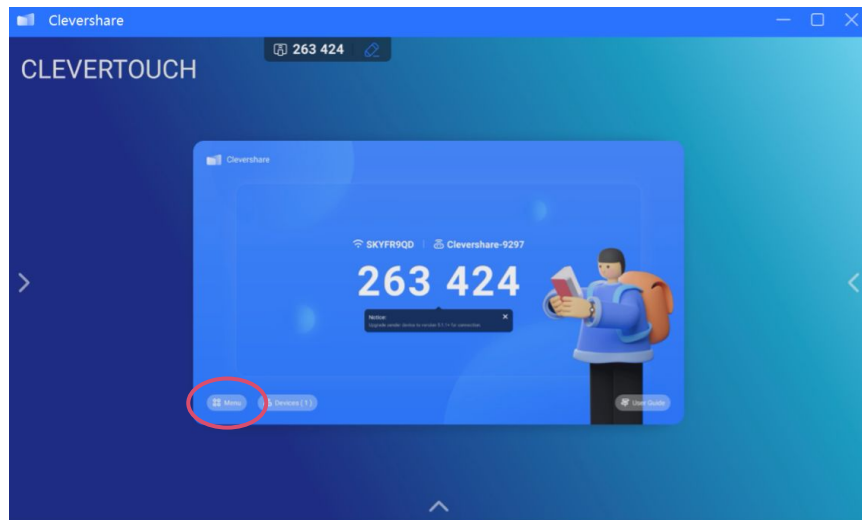

Select **Settings**

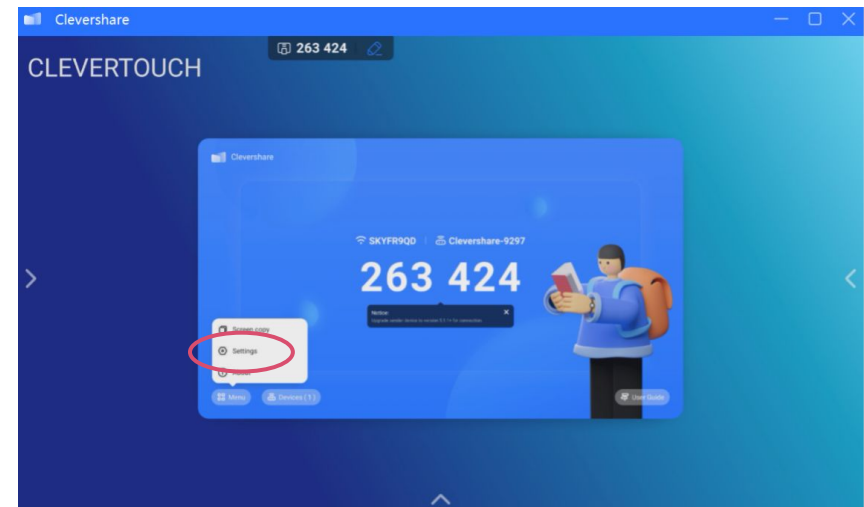

Allow this device to be discovered

After opening, the sender will connect to this device through search

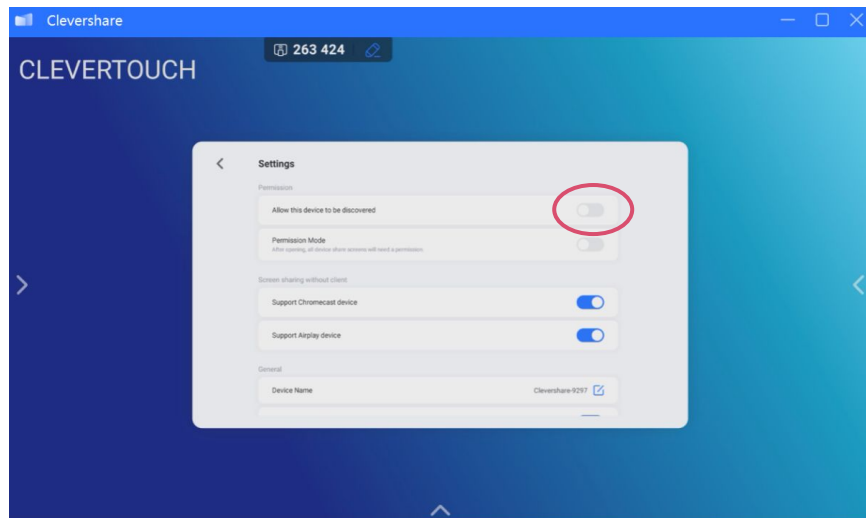

Permission Mode

After opening, all device share screens will need a permission

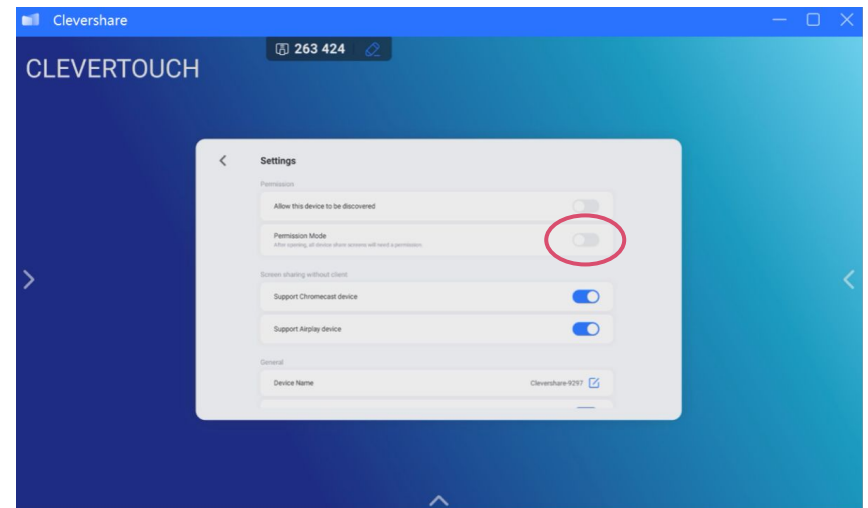

Screen sharing without client

This section includes support for chromecast devices and airplay devices

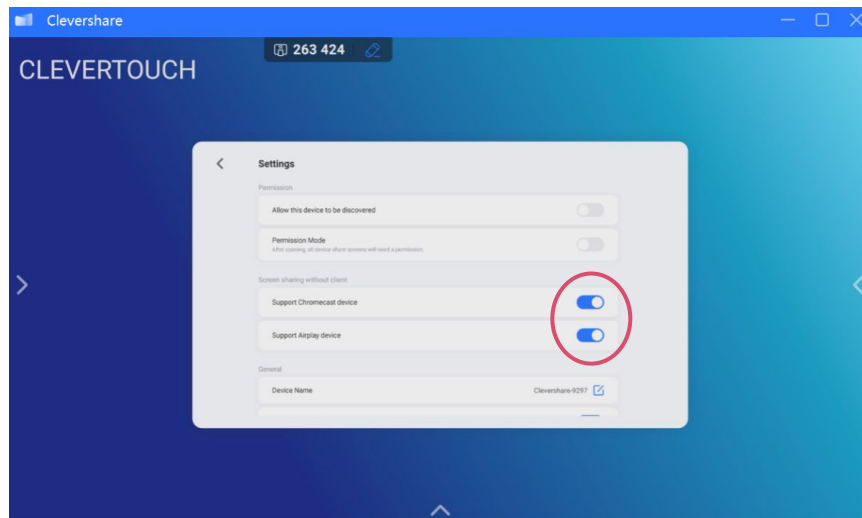

NOTE: On the Clevertouch screen swipe down to see additional settings

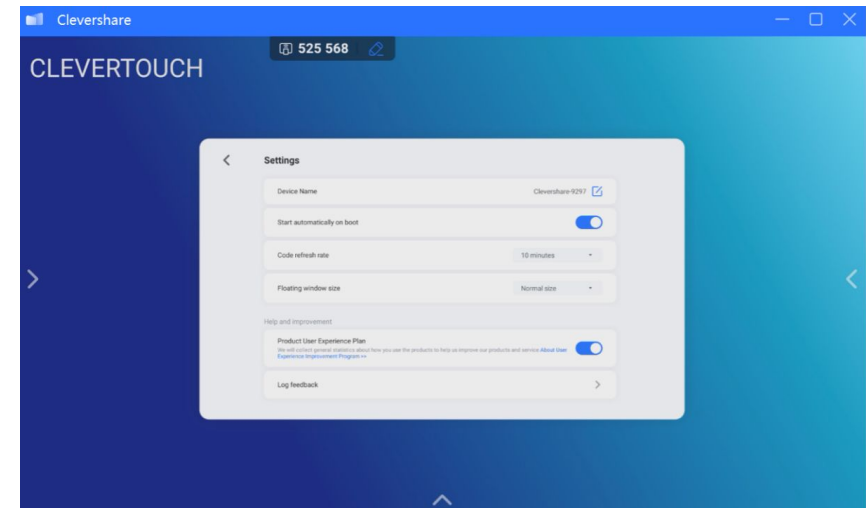

Clevershare 5 app

Download the **Clevershare Pro** app from the apple store or google play.

NOTE: You can also download this app for windows, Mac and Chromebook from the following link:

<https://archive.clevertouch.com/clevershare2g>

On your mobile device, select the **Clevershare app**, insert the 6-digit code.

Depending on your device, swipe up from the bottom or from the top right and select screen mirroring. If you are using a Mac or PC, select start mirroring.

On the mobile device, select photo to share on the Clevertouch screen, camera to record and show on the Clevertouch screen.

Select Remote to take control of the Clevertouch screen and desktop sync to transfer the contents of the Clevertouch screen to the mobile device.

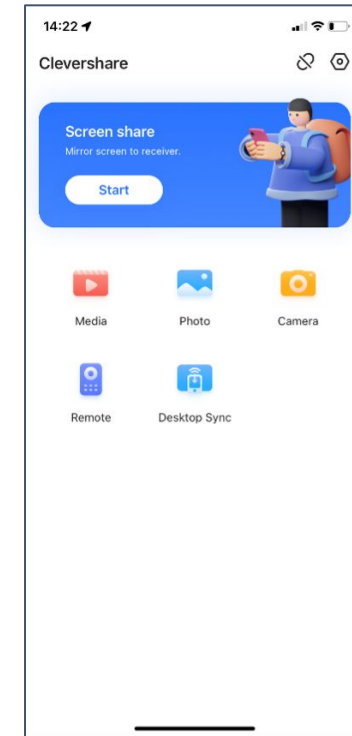

Clevershare 5 Windows app

Double tap the **Clevershare Pro** Windows app

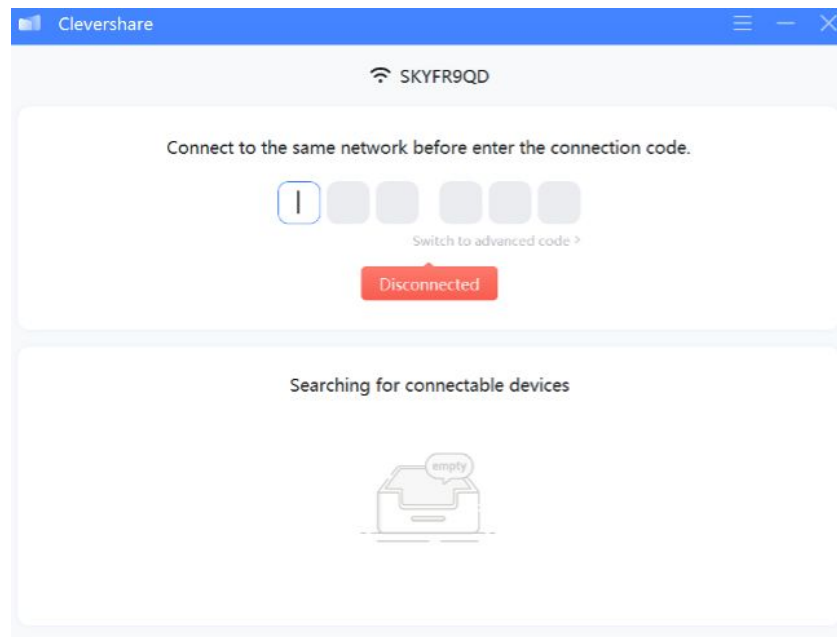

Insert the 6-digit code, select **Screen Share** to mirror screen to receiver and **Desktop Sync** to mirror the receiver on your screen

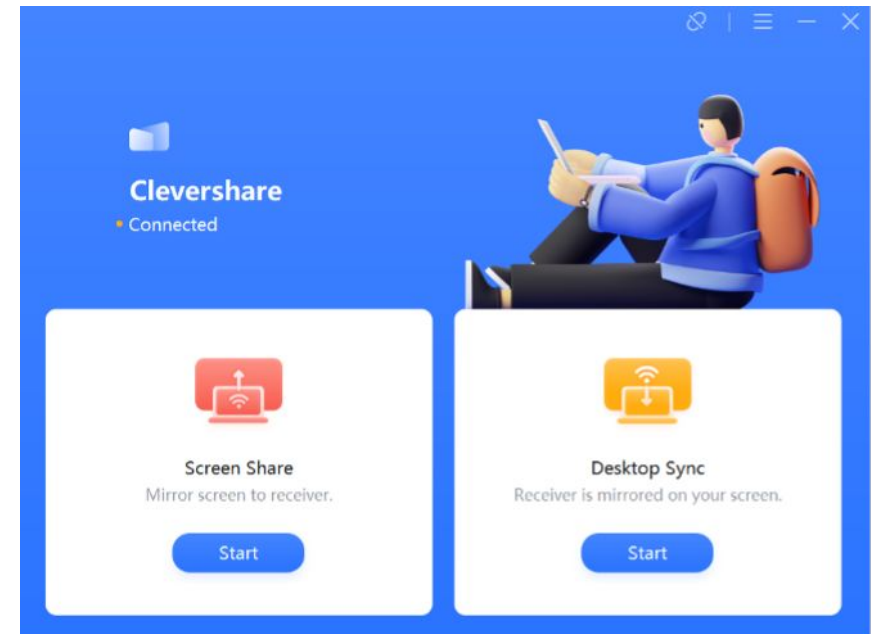

NOTE: When using Desktop Sync, go to the Clevertouch screen, accept or reject and select start now when the message appears on the screen

Device Management

Select **Devices** to bring up the Device Management window

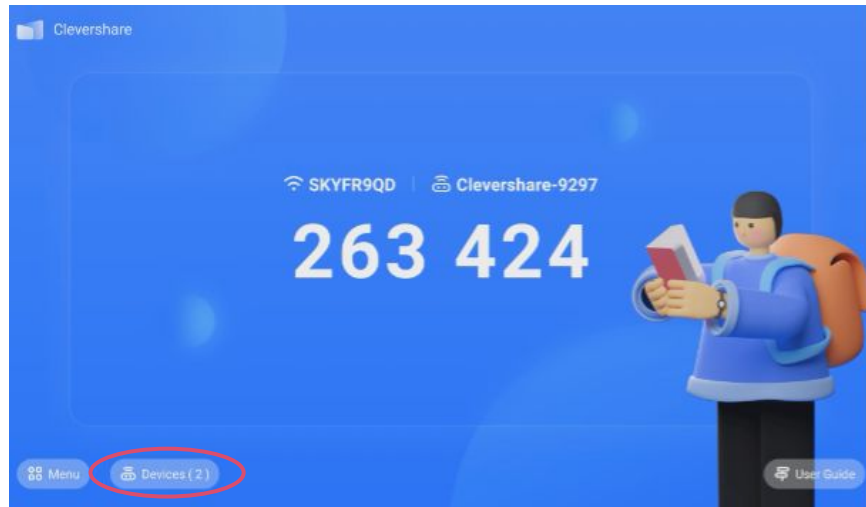

The device management page shows all connected devices. To disconnect devices select the disconnect icon

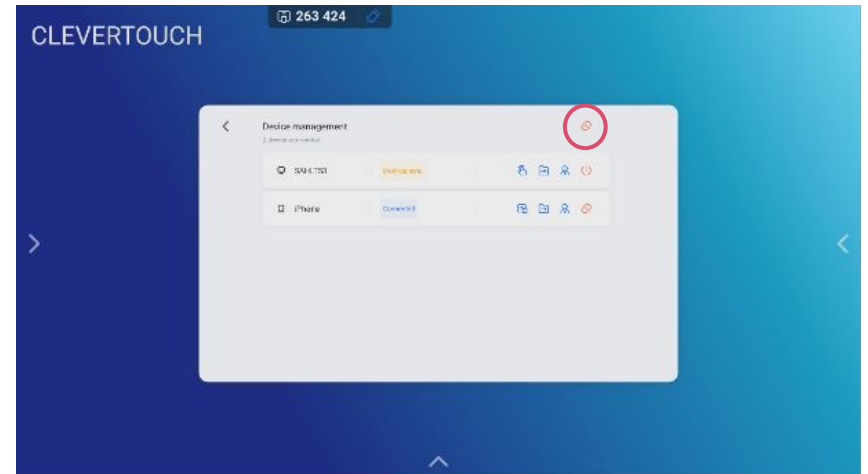

-  Authorized touch, when selected the following menu appears

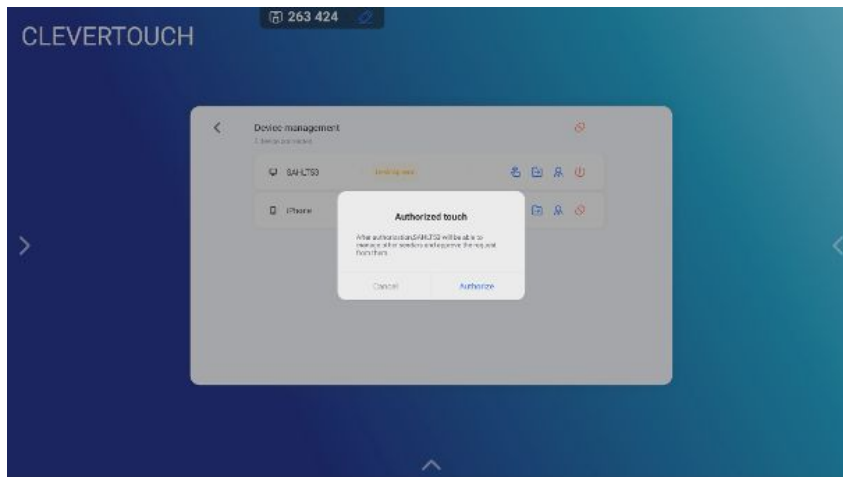

NOTE: A small orange tick appears within the touch icon to denote touch authorized

-  File on the server can be sent to any connected device

-  Authorized management, when selected the following menu appears, allowing the connected device to be able to manage other senders and approve the request from them

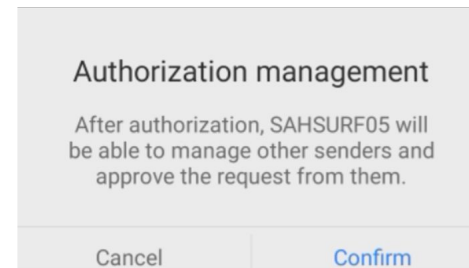

NOTE: A small orange tick appears within the management icon to denote authorization

A granted to manager message will appear on the CleversharePro windows app, these senders can be managed by clicking the device management list

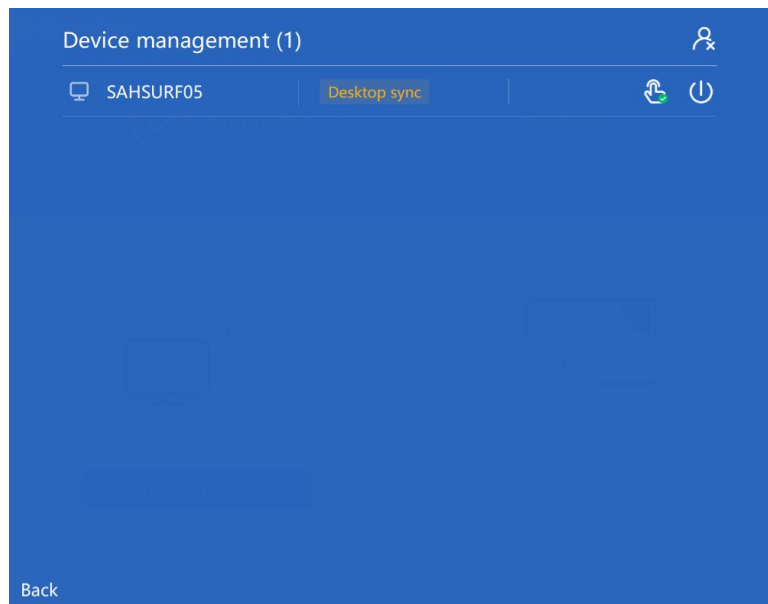

Stop sharing or disconnect from admin, when selected the following appears

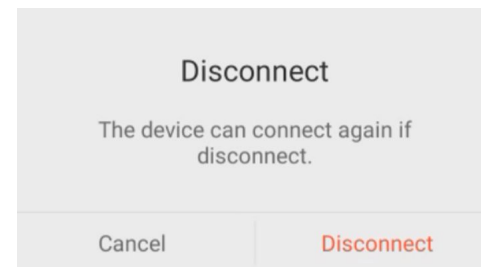

Screen Copy

Select **Screen Copy** from the Clevershare menu

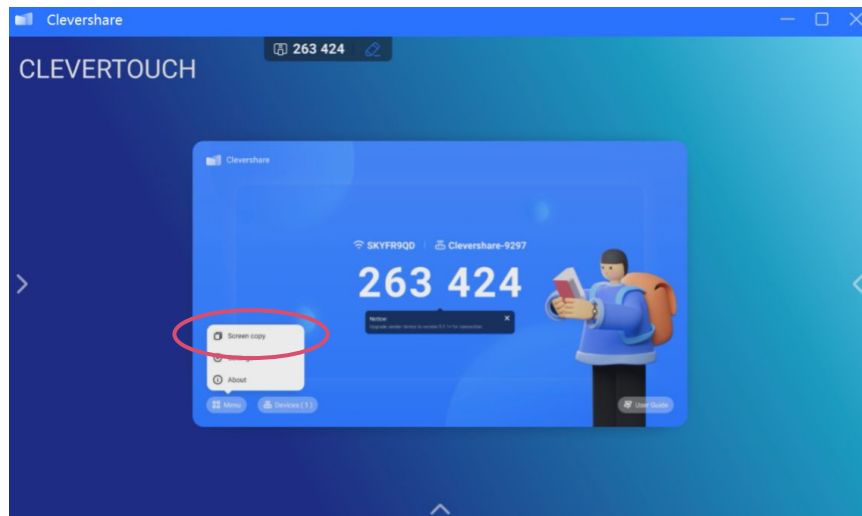

Screen copy allows you to make a group of displays, copy from one screen to another to allow them to show the same content. The content can be from a sender device or anything on the display.

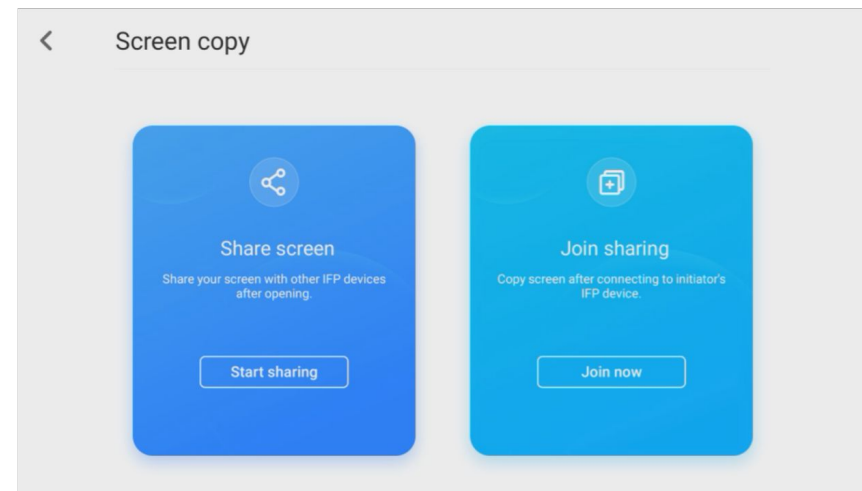

Select **Screen copy – Start Sharing** from the source device
Select **Screen copy – Join Now** from the target device
All target devices will sync the desktop from the source

Additional Features when using Desktop Sync

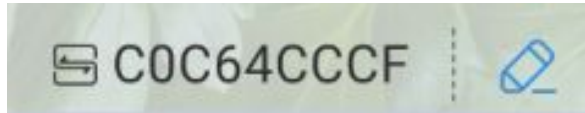

An icon will appear adjacent to the Clevershare code. Select the pen icon



Select the **Pen** icon to annotate

Select the **Eraser** icon to erase annotations

Select the **Clean** icon to clear the screen of annotations

Select the **Save** icon to save a screenshot to the Clevertouch screen

Select the **Insert** icon to save the screenshot into the whiteboard app

Select the **Share** icon to share with the connected device